

# CASE STUDY



## SOLIDWORKS FASTER OUR DESIGNS, EXPANDS PRODUCT LINE

“EATA PLAST & FABRICS” from last four decades, is an ISO 9001 certified company, has been machining high-quality products in the foundry engineering industry.

With his 25-years’ experience, Mr. Batuk P. Shah and Mr. Joy Joseph with his 15 years practical experience joined hands and established the company in Mumbai in 1970. Over the years, it developed from a small craft industry, which mainly dealt with local operators, into a company whose products are exported all over the world.

Yet, it maintains its creative skills and its skills and its capability of handling unforeseen events as well as adapting to the most complex situations, that are typical features of a big and reliable Indian Company.

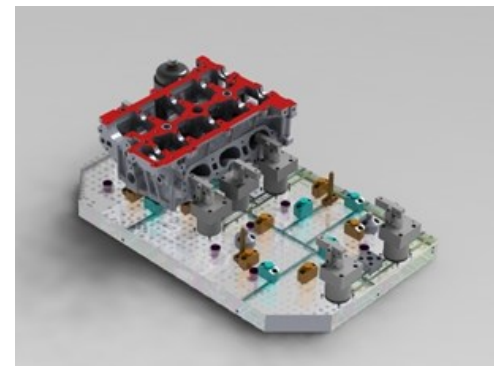
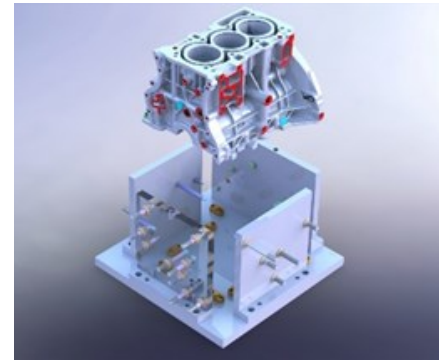

SOLIDWORKS is the most powerful CAD solution, developing the project which, once validated comes the tool room in picture which develop all the intricate and precise components involved and are assembled, this is where the 3D model is translated into reality. This Design Software is Easy to use and speed up design.

- Mr. Nikhil Shivram  
Design Head

### CHALLENGES :

- Development of Products with 3D Modelling
- Overdesigning of products.
- Better Visualization of End Product in the Designing Stage.
- Reworking of Parts at Assembly.

### SOLUTION :

Implemented SOLIDWORKS Standard for 3D modelling of parts and assembly .

### CUSTOMER BENEFITS :

- Reduced Design & Development cycle time.
- Improved product Quality, Marketability, Design Visualization & Presentation.
- Improved team performance to all-time high.
- Enhanced design visualization.

